

BeSafe®

User Manual

iZi Sleep Isofix

GB



GROUP
0/0+

WEIGHT
0-13

AGE
0-12m

iZi Sleep Isofix™

www.izisleep.com

Complies with revised
standard:

ECE R44/04

Tested and Approved



AIRBAG

EXTREME HAZARD:
Do not use on
passenger seats fitted
with activated airbag

ECE R44/04
semi-universal 0-13 kg



04443714

Thank you for choosing BeSafe iZi Sleep ISOfix

⚠ It is important that you read this user manual BEFORE installing your iZi Sleep ISOfix. Incorrect installation could endanger your child.

Safety and convenience

As you and we know, safety comes first when children are involved. For that reason the iZi Sleep ISOfix complies to and exceeds the highest safety requirements.

In order to provide as much convenience as possible, the iZi Sleep seat introduces its innovative reclining-system: outside the car, your child can comfortably rest and sleep in the iZi Sleep, being put completely flat.

⚠ DO NOT use the seat in sleeping position when installed in your car.

'Safe-to-drive' indication

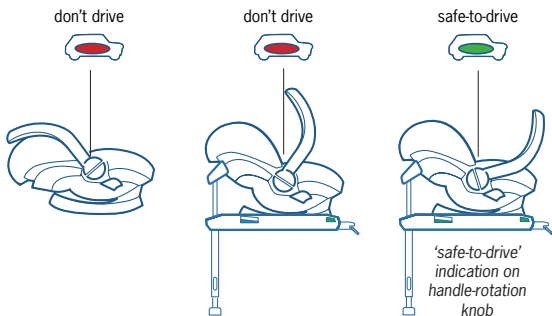

Contents

Vital information	3
iZi Sleep ISOfix usage	4
Preparing to install	5
Fitting your child in the iZi Sleep	6
ISOfix installation	8
Warning: Potential misuse	12
Removing ISOfix	13
Sleeping position	16
After an accident	17
Guarantee	17
Important advise	18
Point of sale information	20

Vital information



- EXTREME HAZARD - DO NOT use on a passenger seat fitted with activated airbag.



- Rear facing installation only.
- DO NOT use the iZi Sleep ISOfix in sleeping position when installed in your car.
- ONLY use the iZi Sleep ISOfix on forward facing car seats.

iZi Sleep ISOfix usage

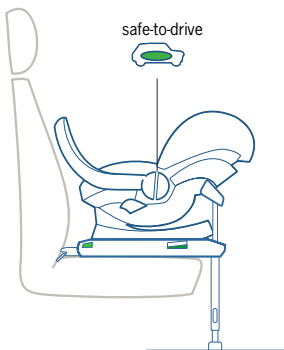

Check the car manufacturers handbook for **detailed** information on ISOfix.

For belt installation and product care see iZi Sleep manual.

Without the ISOfix base the iZi Sleep can be installed with the car belt.

Positioning in car:

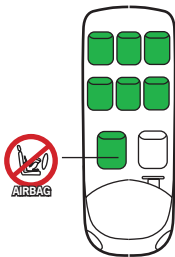

The iZi Sleep ISOfix is suitable for fixing into the seat positions of the cars listed in the appendix 'carlist'.

Rear facing installation:

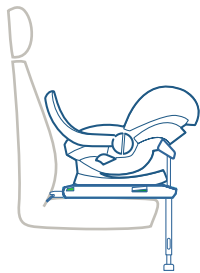

Only rear facing installation allowed.

Preparing to install

Crucial parts

- 1 Instruction label
- 2 Storage user manual
- 3 Base
- 4 Connector release switches
- 5 Connectors

- 6 Insertion clips 2x (bottom side)
- 7 iZi Sleep release switches
- 8 Floor support release switch
- 9 Floor support

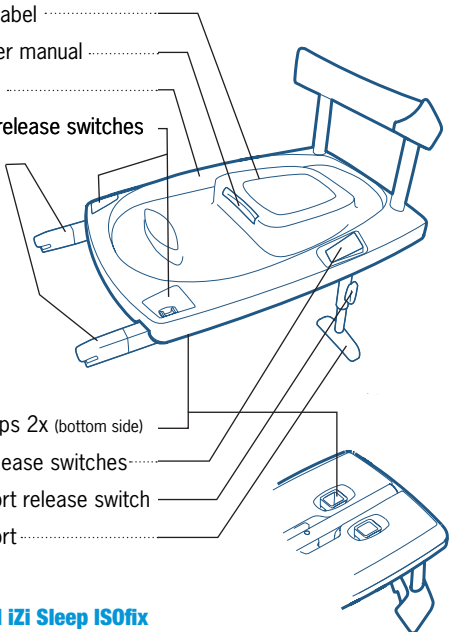

Second-hand iZi Sleep ISOfix

BeSafe advises that child seats should not be bought or sold second-hand. Many seats sold through local advertising have been found to be dangerous.

Fitting your child in the iZi Sleep

When the child weighs over 13kg or the child's head grows above the seat, the child should change to the iZi Comfort group 1 seat or the iZi Combi group 0/1 seat.

⚠ You must adjust the shoulder belt of the harness to the correct position for your child before installing the seat. The harness must be fastened and adjusted correctly at all times. Children should be encouraged to remain within the harness system.

1



Position of the shoulder belt:

Check that the shoulder belt slots are level with your child's shoulders.

2

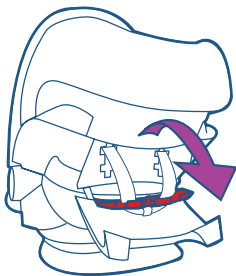

Adjusting the shoulder belts:

Open the storage compartment on the back of the iZi Sleep. Detach the shoulder belt adjuster, and place it in the correct position by supporting the belt from the inside. (see illustration above). Make sure adjuster is clicked in.

3

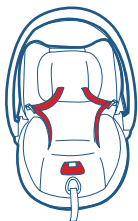

Fastening the harness:

Lay the shoulder belts over the sides of the iZi Sleep, before your child is seated. Put the child in the seat.



Place the belts over the shoulder and close the harness buckle. Pull the central adjuster straight down. Just two fingers should fit between child and shoulder belt. Make sure the belts are not twisted.

ISOfix installation

⚠ Make sure the indicators on the connector release switches are green before you drive.

⚠ Make sure the floor support is fully pushed down.

⚠ **EXTREME HAZARD - DO NOT use on a passenger seat fitted with activated airbags.**



①

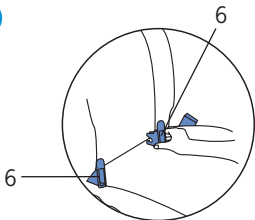

Clip the insertion clips (6) onto the ISOfix anchorage points on the vehicle seat (between seat and backrest). The insertion clips should be removed when not in use.

②

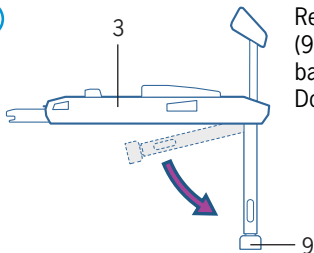

Release the floor support (9) from underneath the base (3). Do this outside the car.

3

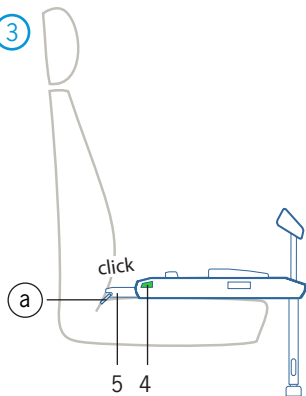

Place the base on the car seat. Click the ISOfix connectors (5) in the ISOfix anchorages (a). **Make sure** both indicators on the connector release switches (4) are GREEN.

4

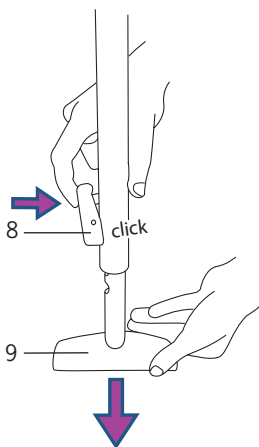

Unlock the floor support release switch (8) and push the floor support (9) down till it has contact with the floor of the car.

Continue with step 5, on the next page.

5

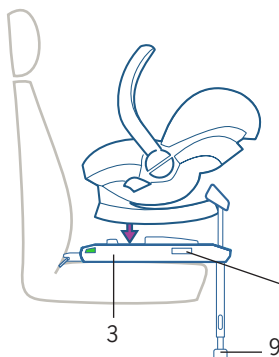

Place the iZi Sleep on the base (3). Check if the iZi Sleep release switches (7) are up and indicates green. If the switch is not up and does not indicate green check if the floor support (9) is folded out (step 2).

6

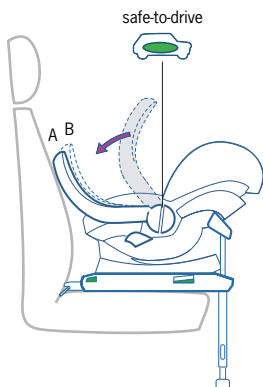

Move the carrying handle to the 'safe-to-drive' position by pushing the handle release buttons on the inside of the handle. Push the carrying handle towards the car seat as far as possible. There are two safe-to-drive positions A and B.



safe-to-drive



don't drive

Check the 'safe-to-drive' indication on the carrying handle, near the handle release button.

'safe-to-drive' indication on handle-rotation knob

Correct installation

All six indicators (three left and three right) must show green!

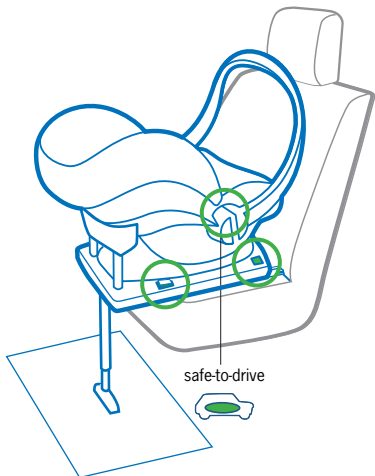

Warning: Potential misuse

⚠ Installation behind an activated airbag is forbidden.



⚠ Carrying handle in carrying position is forbidden, “safe-to-drive” indication is red.

⚠ Always fold out the floor support. The iZi Sleep release switch must show green.



⚠ Never use the car seat belt in combination with the iZi Sleep ISOfix base.

Removing iZi Sleep ISOfix

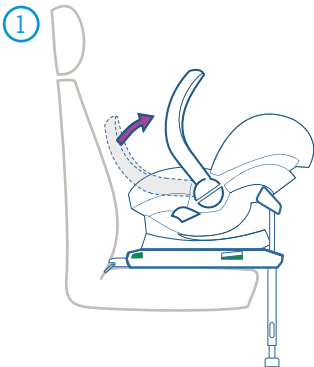

Move the carrying handle to the carrying position by pushing the handle release buttons on the inside of the handle.

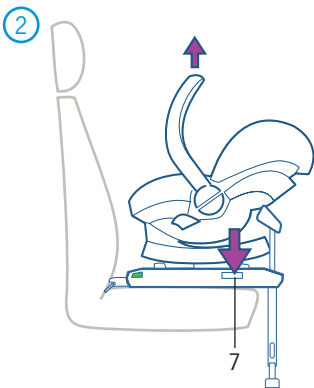

Remove the iZi Sleep while pressing one of the iZi Sleep release switches (7).

3

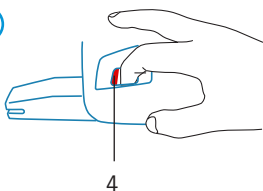

To release the ISOfix anchorages, pull the connector release switches (4) on both sides. Afterwards the indicators should show red.

4

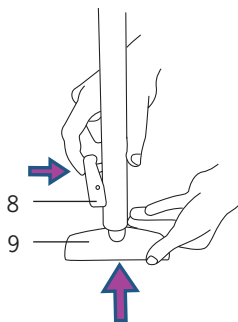

Unlock the floor support release switch (8) and push the floor support (9) fully up.

5

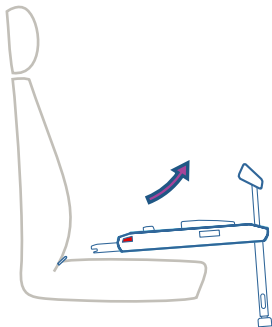

Take the iZi Sleep ISOfix base out of the car.

6

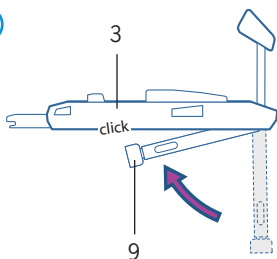

Store the floor support (9) underneath the base (3).

7

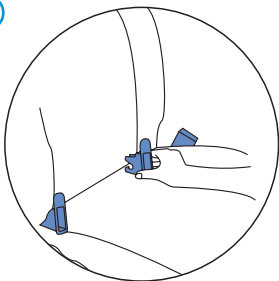

Remove the insertion clips from the vehicle seat and store them underneath the base.

Sleeping position

⚠ DO NOT use the seat in sleeping position when installed in your car.

Your child can comfortably rest and sleep in the iZi Sleep, when put in the sleeping position (only outside the car) . To put the iZi Sleep into the sleeping position, push both handle release buttons on the inside of the carrying handle and move the handle to the head of the iZi Sleep.

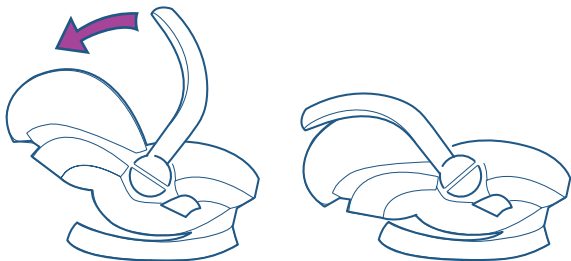

Cleaning the iZi Sleep ISOfix

Do not use any aggressive cleaning products; these may harm the construction material of the iZi Sleep. Clean by hand with water and mild soap.

After an accident

After an accident, the iZi Sleep and the ISOfix base should be replaced. Although they may look undamaged, if you were to have another accident, the iZi Sleep and the ISOfix base may not be able to protect your child as well as they should.

Guarantee

All BeSafe products are carefully designed, manufactured and tested. All BeSafe child safety seats are tested periodically out of our continuous production in our test laboratory. Furthermore they are tested by independent test institutes.

Should this product prove faulty within 24 months of purchase due to materials or manufacturing fault, except covers and child safety belt, please return it to the original place of purchase.

The guarantee is only valid when you use your seat and ISOfix base appropriately and with care. Please contact your dealer, he will decide if the seat will be returned to the manufacturer for repair. Replacement or return cannot be claimed. The guarantee does not get extended through repair.

The guarantee expires:

- When there is no receipt.
- When defects are caused by wrong and improper use .
- When defects are caused by abuse, misuse or negligence.

Important advice

- ⚠ - Be aware of the 'safe-to-drive' indication.
- Make sure both the internal child safety belts are tightened firmly, in order to prevent any unwanted dislocation of child. Check frequently.
- DO NOT use anything, such as a cushion or coat, to raise the iZi Sleep ISOfix off the passenger seat. In an accident the iZi Sleep ISOfix will not be able to protect your child as well as it should.
- All passengers should be fastened by a safety belt.
- Make sure all passengers are informed on how to release your child in case of emergency.
- Make sure luggage or other objects are properly secured.
- Unsecured luggage may cause severe injuries to children and adults in case of accidents
- Rigid items and plastic parts of the iZi Sleep and ISOfix base must be so located and installed that they are not liable, during everyday use of the vehicle, to become trapped by a movable seat or in a door of the vehicle.
- An unoccupied iZi Sleep and ISOfix base should still be fastened.
- DO keep this user manual in the storage component of the base.
- DO NOT attempt to dismantle, modify or add any part of the iZi Sleep ISOfix.
- Warranty will expire if non-original parts or accessories are used.

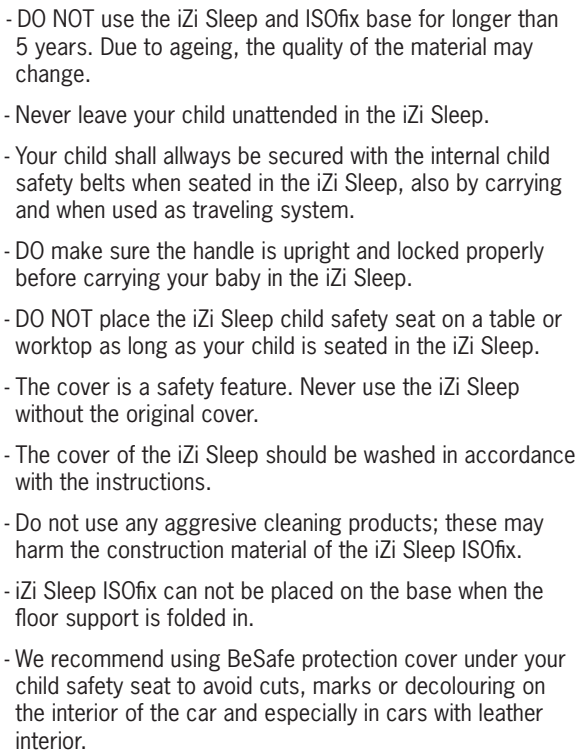
- 
- DO NOT use the iZi Sleep and ISOfix base for longer than 5 years. Due to ageing, the quality of the material may change.
 - Never leave your child unattended in the iZi Sleep.
 - Your child shall always be secured with the internal child safety belts when seated in the iZi Sleep, also by carrying and when used as traveling system.
 - DO make sure the handle is upright and locked properly before carrying your baby in the iZi Sleep.
 - DO NOT place the iZi Sleep child safety seat on a table or worktop as long as your child is seated in the iZi Sleep.
 - The cover is a safety feature. Never use the iZi Sleep without the original cover.
 - The cover of the iZi Sleep should be washed in accordance with the instructions.
 - Do not use any aggressive cleaning products; these may harm the construction material of the iZi Sleep ISOfix.
 - iZi Sleep ISOfix can not be placed on the base when the floor support is folded in.
 - We recommend using BeSafe protection cover under your child safety seat to avoid cuts, marks or decolouring on the interior of the car and especially in cars with leather interior.

Point of sale information

Notice:

1. This is an ISOFIX CHILD RESTRAINT SYSTEM. It is approved to Regulation No. 44.04 series of amendments for general use in vehicles fitted with ISOFIX anchorages systems.
2. It will fit vehicles with positions approved as ISOfix positions (as detailed in the vehicle handbook), depending on the category of the child seat and of the fixture.
3. The mass group and the ISOfix size class for which this device is intended is: group 0⁺ (0-13 kg)
4. This child restraint is classified for semi-universal use and is suitable for fixing into the seat positions of the cars mentioned in the carlist.

 EXTREME HAZARD - DO NOT use on a passenger seat fitted with activated airbags.

 DO NOT use the seat in sleeping position when installed in your car.

BeSafe[®]

GB - 2007 - V 6.2
B315_N2000970

for more information:
N-3535 Krøderen, Norway
www.besafe.eu
www.hts.no